

Pursuant to Section 336(b) of the Sustainable Planning Act 2009, this plan forms part of Council's approval for

Approval No: 5688/06

Date: 29 August 2006

Signed: *7.7.2014*

Date: 28 March 2014

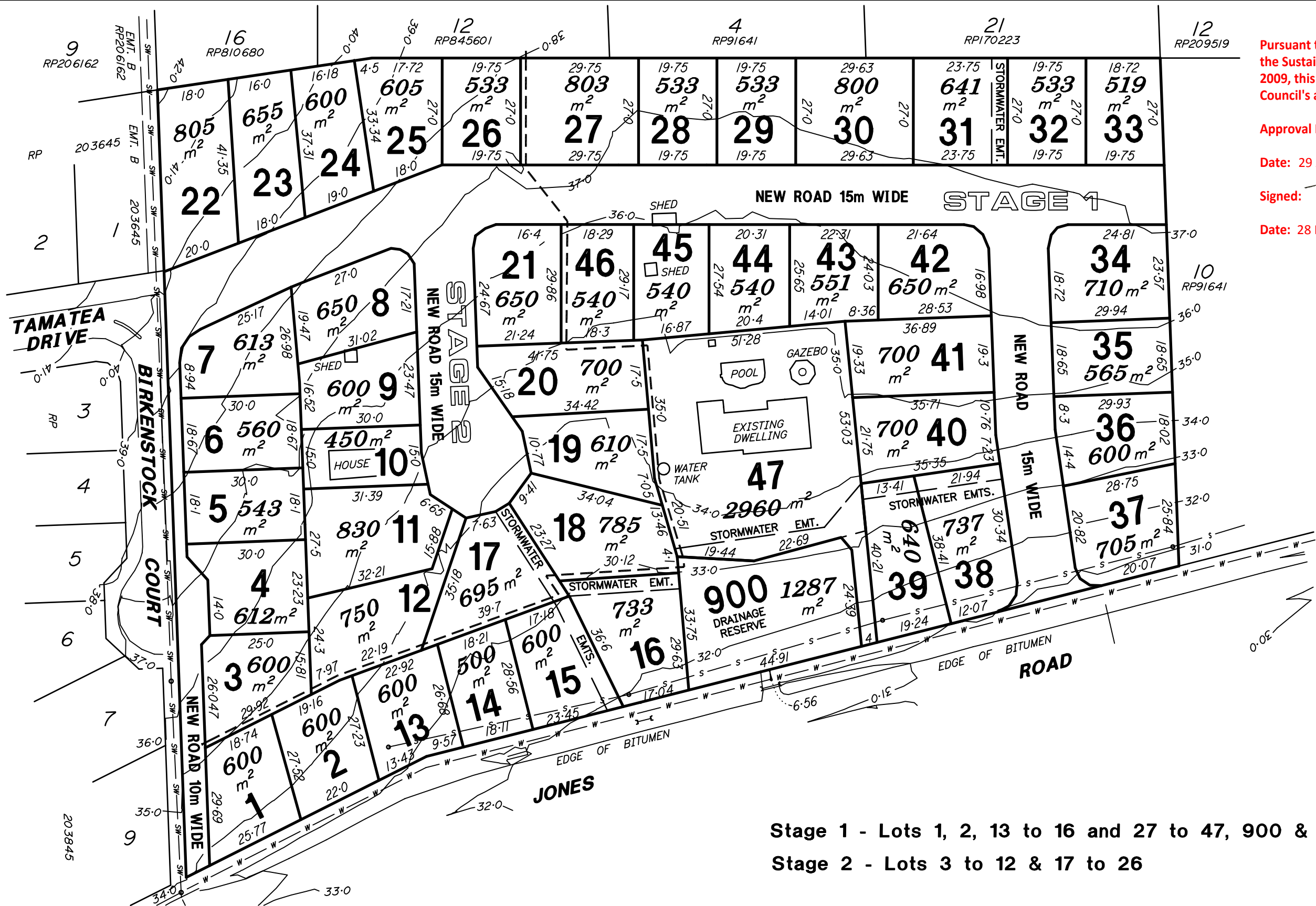

Stage 1 - Lots 1, 2, 13 to 16 and 27 to 47, 900 & 901
Stage 2 - Lots 3 to 12 & 17 to 26

A3 ORIGINAL

Scale: 1 : 1000
0 10 20 30 40

The Area and Distances on this plan are approximate only and are subject to Local Authority Approval and Final Survey.
The Contours on this Plan are for Subdivisional Layout Design purposes only and should not be used for any other purpose.

Local Authority
IPSWICH CITY COUNCIL

Horizontal Datum
RP 91641

Vertical Datum
Topo Map
Origin
Contour Interval 1.0m

Revisions:	Date	By

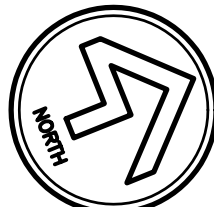

Title:
**PLAN OF PROPOSED
RECONFIGURATION OF LOTS
LOTS 11 - 14 ON RP 91641**

Project
**248 - 272 JONES ROAD
BELLBIRD PARK**

Parish:
GOODNA

County:
STANLEY

**NEIL WOODFORD
& ASSOCIATES** PTY. LTD.
A.C.N. 010 662 996
CONSULTING SURVEYORS



P.O. BOX 31
REDBANK Q. 4301
Phone: 3818 1971
Facsimile: 3818 1941
Email: survey@neilwoodford.com

Client:
Plot:
4 December 2013 SB

Computer Files:
509A-10.DWG

Job Ref:
509A

Drawing No:
PP/10